

VEINLITE PEDI

Intended Use/Indications

- Examining the skin surface, finding veins and assisting in vein access in neonates and newborns
- Easier visualization of veins in dark skinned patients



Contraindications

- When used for internal examination
- When used without the disposable plastic cover

BATTERY INSTRUCTIONS

Installing or Replacing Batteries

To install or replace the battery, press firmly on the battery cap [3] and slide it off. Remove the used battery. Install a new CR2 battery, oriented as indicated by the markings inside the battery compartment then slide the battery cover back into place.



Attaching a Lanyard

A lanyard can be attached to the Veinlite PEDI, via the hole at the bottom of the unit [4]. Use a thin cord for this purpose.

Warranty Information

The Veinlite PEDI has a one year parts and labor warranty. Please provide the serial number located under the battery or the outside of the box when you contact TransLite LLC for any warranty issues. The warranty is valid only if the Veinlite PEDI is used according to the manufacturer's instructions. Before returning the Veinlite PEDI to TransLite for repair, you must call or e-mail TransLite to obtain a return authorization code and shipping information before sending your device. No refunds will be given for unauthorized shipping.

Explanation of Symbols

SYMBOL	EXPLANATION
REF	Model Number
SN	Serial Number
	Manufacturer
	EC Representative (EU Only)
	Do not dispose as unsorted municipal waste.



Healthcare & Education Centre Tel: +44 1704 544 944
The Church, Portland Street Fax: +44 1704 544 050
Southport, PR81HU, UK

This product is covered by Patents. Patent Numbers:
7,874,698; 7,841,751; 8,032,205; 8,177,808

VPEDI DFU Rev 6 1116



Manufacturer, TransLite LLC

Tel: (281) 240 3111 www.veinlite.com
Fax: (281) 240 3122 info@veinlite.com



Veinlite PEDI® CE

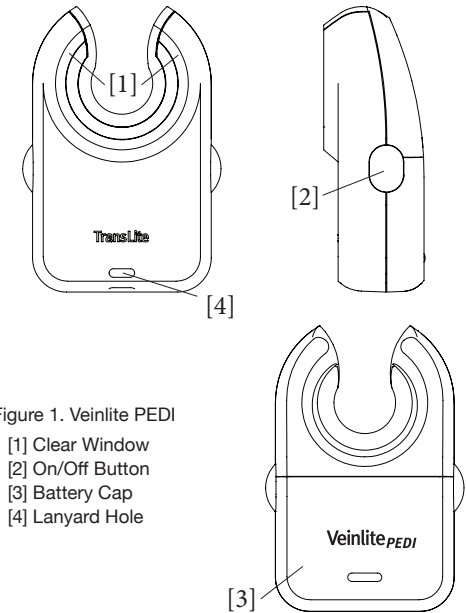

Figure 1. Veinlite PEDI

- [1] Clear Window
- [2] On/Off Button
- [3] Battery Cap
- [4] Lanyard Hole

DIRECTIONS FOR USE

Description

The TransLite Veinlite PEDI is a hand-held battery powered transillumination device for visualizing veins and superficial blood vessels in neonates (0-24 mo). It utilizes the patented* transillumination technique known as side-transillumination, which enables the Veinlite PEDI to uniformly illuminate a small region of skin and subcutaneous tissue, anywhere on the body, without any areas of shadow. The shadow-free side-transillumination technique allows better visualization of veins than any other transillumination method.

OPERATION

- Place the Veinlite PEDI against the patient's skin with the LED side in direct contact with the skin perpendicular to vein direction. Apply gentle pressure to maintain optimal skin contact.
- To turn on the LEDs, press the orange and/or the red button located on the left and right side of the device. Press the selected button(s) a second time to turn the LEDs off.
- Press the orange button if you are examining small superficial veins on fair skin.
- Press the red button to add the red color for examining deeper veins or if the patient's skin is darkly pigmented.

WARNING

DO NOT SHINE THE LED LIGHTS
IN THE PATIENT'S EYES.

USING THE DISPOSABLE PLASTIC COVER

The single-use disposable plastic covers (Product #VPED-DPC) for the Veinlite PEDI MUST be used when the device is placed in contact with a patient's skin.

CAUTION: These plastic covers are not sterile. They should be wiped with a germicidal wipe prior to use.

- Before using Veinlite PEDI, place it inside the disposable cover with the flap on the same side as the LEDs.
- Pull the flap over the device to the other side.
- Wipe the LED side of the Veinlite PEDI and any part of it coming in contact with the patient, with a medically approved germicidal wipe.

Precautions

- Avoid using alcohol on the clear plastic window as this may cause fogging.
- Do not immerse the device in liquid.
- Do not autoclave the device.

- 1 To scan for veins, place device against skin *perpendicular to vein direction*. Scan it forward and backward. Veins will be visible as dark lines due to transillumination.

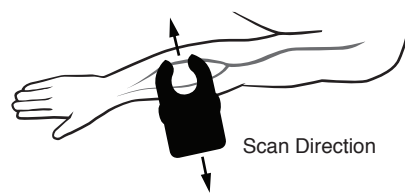

- 2 Once a suitable vein has been identified, rotate device 90°, parallel to vein.

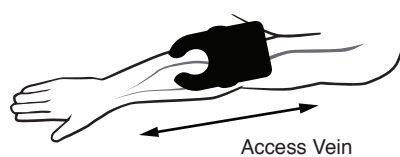

- 3a Apply gentle pressure on the Veinlite PEDI to secure the vein.
- 3b Push back slightly on the Veinlite PEDI to stretch the skin and provide traction.

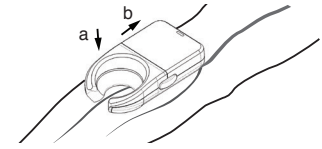

- 4 Insert the needle into the vein, through the opening of the device. NOTE: Discard the single-use disposable plastic cover after each patient.

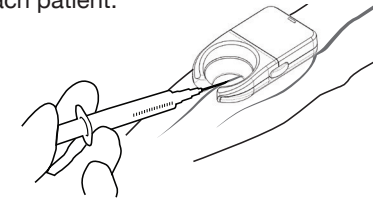

ATTACHMENTS

Two patented*** attachments are included with the Veinlite PEDI:

- A. A snap-on light shield to reduce interference from bright overhead lighting.
- B. A snap-on neonate adapter to reduce the size of the viewing area for use with infants.

The diagrams below indicate how to attach the light shield and neonatal adapter.

A. Veinlite PEDI Light Shield

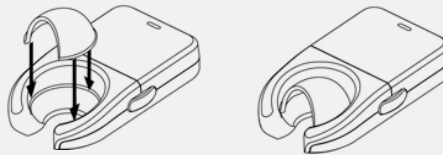

B. Veinlite PEDI Neonate Adapter

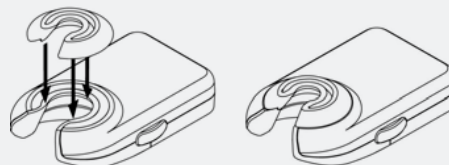

WARNING

Veinlite PEDI is designed for external examination only.

To avoid contamination of the device, Veinlite PEDI must be used with the disposable plastic cover.

To avoid the spread of infection, always change the disposable plastic cover between patients and wipe the new cover with a germicidal wipe.

These devices are intended for use only by clinicians trained in performing vascular access, or under the supervision of a clinician.

Do not look directly into the LEDs while on.